

THE PLAN SHOWS THE "SRI VISHVESHWARI NAGAR" RESIDENTIAL LAYOUT AT R.S.NO.164/3,164/4, 174/1,174/2A,174/2B,ODIYAMPET REVENUE VILLAGE, VILLIANUR COMMUNE, PUDUCHERRY STATE.

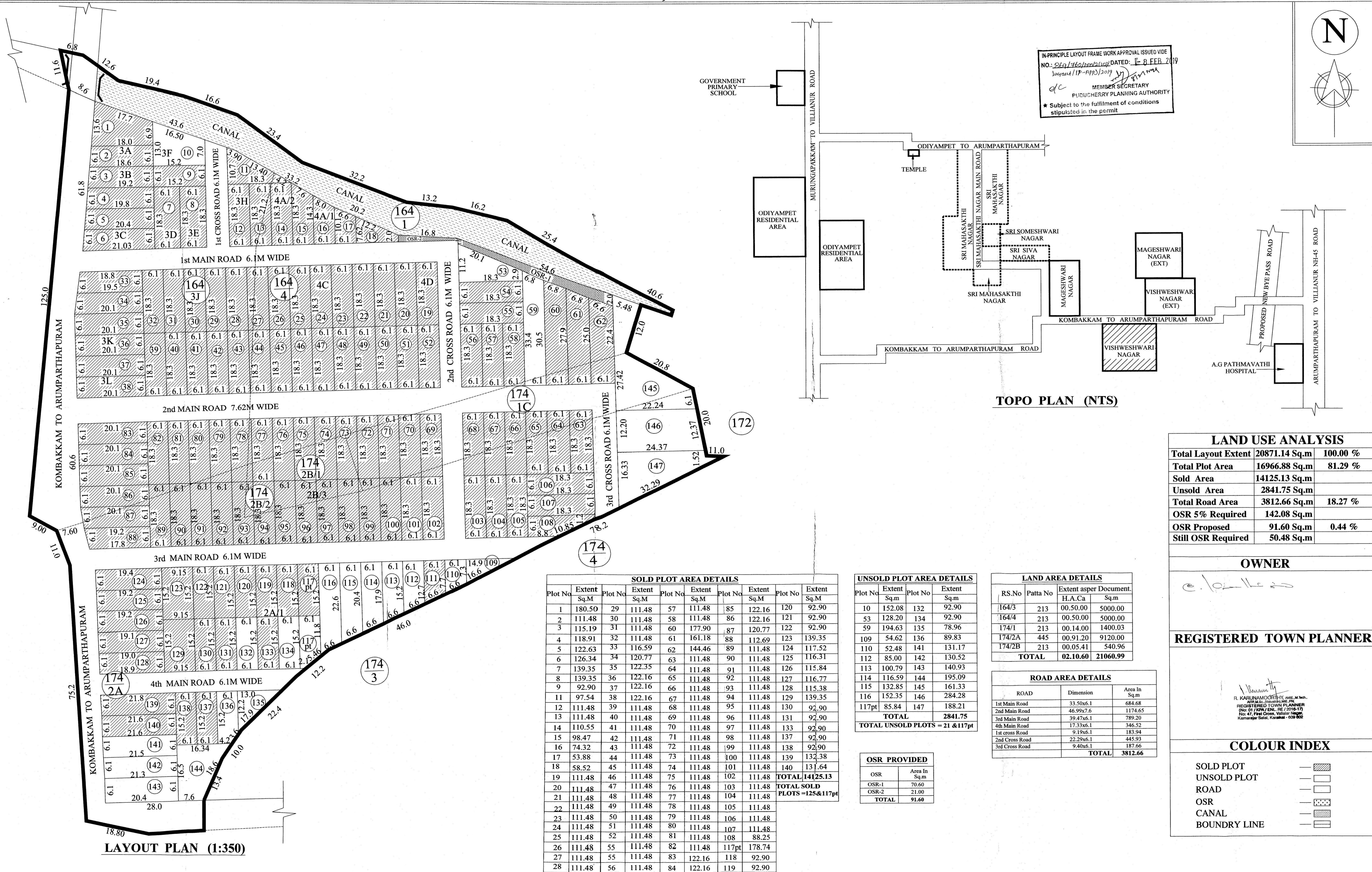

IN-PRINCIPLE LAYOUT FRAME WORK APPROVAL ISSUED WIDE
 NO: 069/136/199/100 DATED: 08 FEB 2019
 Layout/1P-APP/2019
 MEMBER SECRETARY
 PUDUCHERRY PLANNING AUTHORITY
 * Subject to the fulfillment of conditions stipulated in the permit

TOPO PLAN (NTS)

LAND USE ANALYSIS

Total Layout Extent	20871.14 Sq.m	100.00 %
Total Plot Area	16966.88 Sq.m	81.29 %
Sold Area	14125.13 Sq.m	
Unsold Area	2841.75 Sq.m	
Total Road Area	3812.66 Sq.m	18.27 %
OSR 5% Required	142.08 Sq.m	
OSR Proposed	91.60 Sq.m	0.44 %
Still OSR Required	50.48 Sq.m	

OWNER
 e. j. ...

REGISTERED TOWN PLANNER

R. KARUNAMOORTHY, AME, M.Tech.,
 ATT. M.Sc. (Township & Reg. Plan.)
 REGISTERED TOWN PLANNER
 (No. 01 / J.P.P.A. / ENL. / RE / 2016-17)
 No. 47, First Cross, Villianur, Nagapattinam,
 Karaikal District, Karaikal - 605 002

COLOUR INDEX

SOLD PLOT	— [Hatched Box]
UNSOLD PLOT	— [White Box]
ROAD	— [Solid Line]
OSR	— [Dotted Box]
CANAL	— [Wavy Line]
BOUNDRY LINE	— [Double Line]

SOLD PLOT AREA DETAILS

Plot No.	Extent Sq.M	Plot No.	Extent Sq.M	Plot No.	Extent Sq.M	Plot No.	Extent Sq.M
1	180.50	29	111.48	57	111.48	85	122.16
2	111.48	30	111.48	58	111.48	86	122.16
3	115.19	31	111.48	60	177.90	87	120.77
4	118.91	32	111.48	61	161.18	88	112.69
5	122.63	33	116.59	62	144.46	89	111.48
6	126.34	34	120.77	63	111.48	90	111.48
7	139.35	35	122.35	64	111.48	91	111.48
8	139.35	36	122.16	65	111.48	92	111.48
9	92.90	37	122.16	66	111.48	93	111.48
11	97.54	38	122.16	67	111.48	94	111.48
12	111.48	39	111.48	68	111.48	95	111.48
13	111.48	40	111.48	69	111.48	96	111.48
14	110.55	41	111.48	70	111.48	97	111.48
15	98.47	42	111.48	71	111.48	98	111.48
16	74.32	43	111.48	72	111.48	99	111.48
17	53.88	44	111.48	73	111.48	100	111.48
18	58.52	45	111.48	74	111.48	101	111.48
19	111.48	46	111.48	75	111.48	102	111.48
20	111.48	47	111.48	76	111.48	103	111.48
21	111.48	48	111.48	77	111.48	104	111.48
22	111.48	49	111.48	78	111.48	105	111.48
23	111.48	50	111.48	79	111.48	106	111.48
24	111.48	51	111.48	80	111.48	107	111.48
25	111.48	52	111.48	81	111.48	108	88.25
26	111.48	55	111.48	82	111.48	117pt	178.74
27	111.48	55	111.48	83	122.16	118	92.90
28	111.48	56	111.48	84	122.16	119	92.90

TOTAL SOLD PLOTS = 125 & 117pt

UNSOLD PLOT AREA DETAILS

Plot No.	Extent Sq.M	Plot No.	Extent Sq.M
10	152.08	132	92.90
53	128.20	134	92.90
59	194.63	135	78.96
109	54.62	136	89.83
110	52.48	141	131.17
112	85.00	142	130.52
113	100.79	143	140.93
114	116.59	144	195.09
115	132.85	145	161.33
116	152.35	146	284.28
117pt	85.84	147	188.21

TOTAL UNSOLD PLOTS = 21 & 117pt

OSR PROVIDED

OSR	Area In Sq.m
OSR	91.60
OSR-1	70.60
OSR-2	21.00
TOTAL	91.60

LAND AREA DETAILS

RS.No	Patta No	H.A.Ca	Sq.m
164/3	213	00.50.00	5000.00
164/4	213	00.50.00	5000.00
174/1	213	00.14.00	1400.03
174/2A	445	00.91.20	9120.00
174/2B	213	00.05.41	540.96
TOTAL	02.10.60	21060.99	

ROAD AREA DETAILS

ROAD	Dimension	Area In Sq.m
1st Main Road	33.50x6.1	684.68
2nd Main Road	46.99x7.6	1174.65
3rd Main Road	39.47x6.1	789.20
4th Main Road	17.33x6.1	346.52
1st cross Road	9.19x6.1	183.94
2nd Cross Road	22.29x6.1	445.93
3rd Cross Road	9.40x6.1	187.66
TOTAL		3812.66

LAYOUT PLAN (1:350)