

**PLAN SHOWS THE "SRI SAMBAVI NAGAR EXTENSION" RESIDENTIAL LAYOUT AT R.S.No.110/4pt,VILLIANUR REVENUE VILLAGE,VILLIANUR COMMUNE,PUDUCHERRY STATE.**

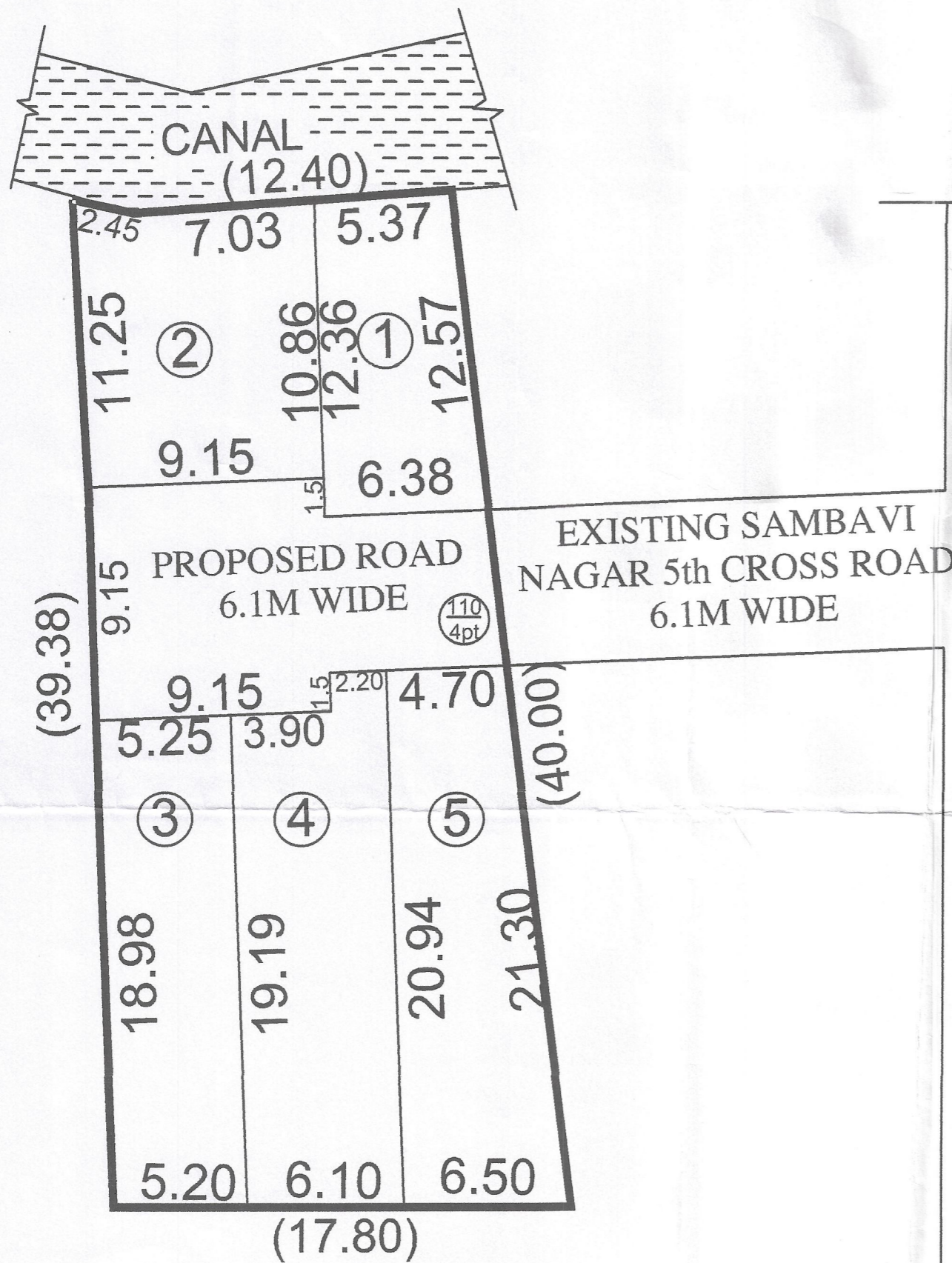

**EXISTING SAMBAVI NAGAR  
1st MAIN ROAD 7.62M WIDE**

**MUNICIPALITY ROAD 9.15M WIDE TO VILLIANUR**

LAYOUT PLAN scale :(1:100)

008862  
6 MAR 2021  
Layout Plan Approved  
No.PPA/1591/3426/2(Layout/VCP)/2020  
16/3/2024  
MEMBER SECRETARY  
PUDUCHERRY PLANNING AUTHORITY,  
VILLUPURAM

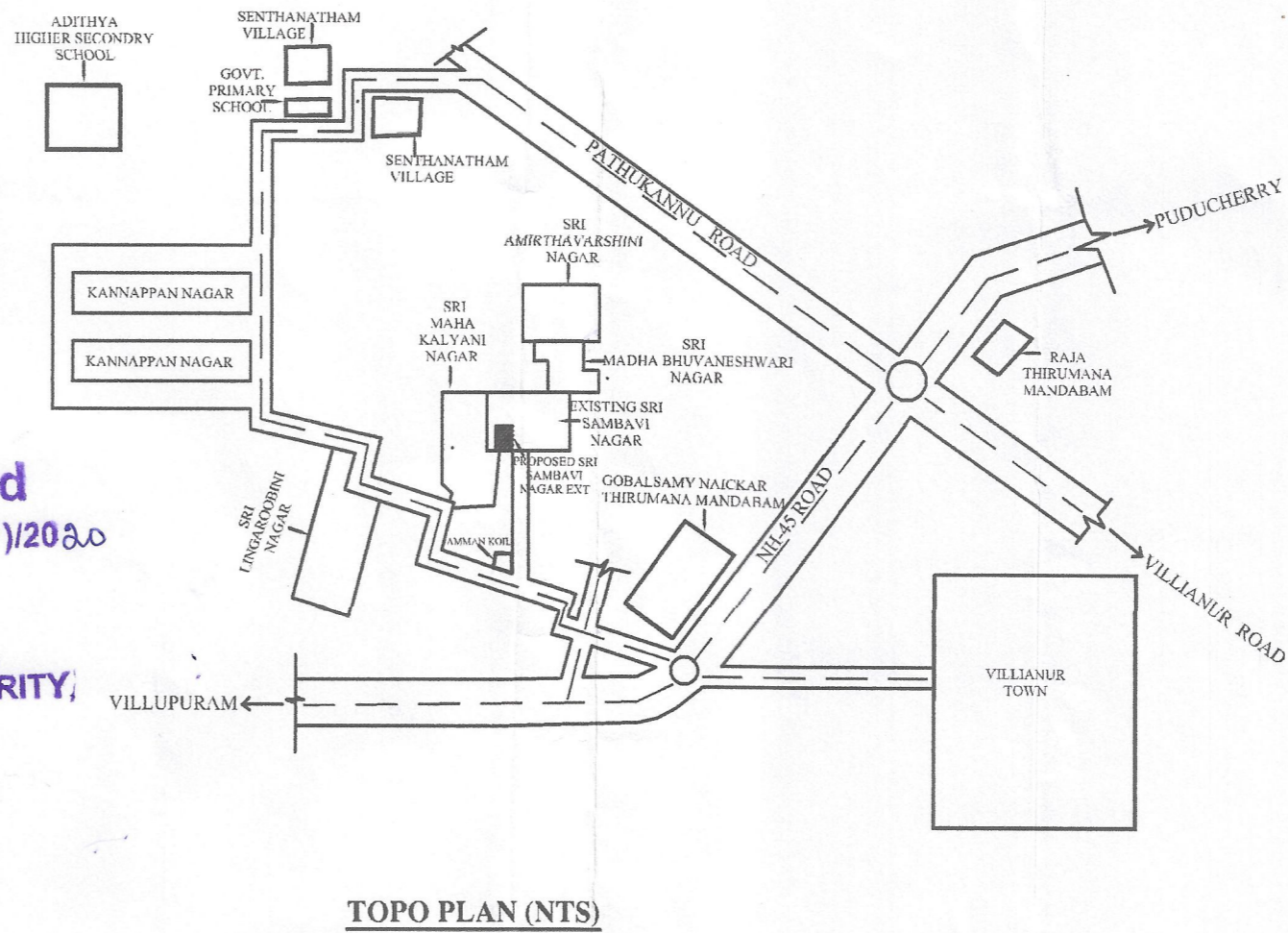

LAND AREA DETAILS			
RS.No	Patta No	Extent In	
		Sq.m	Sq.ft
110/4pt	275	636.20	6848

LAND USE ANALYSIS		
Total Layout Extent	636.20 Sq.m	100.00 %
Total Plot Area	512.40 Sq.m	80.54 %
Total Road Area	123.80 Sq.m	19.46 %

ROAD AREA DETAILS			
Sl.No	Name Of The Road	Area In Sq.m	Area In Sq.ft
1	Proposed Road (6.10 M)	40.50	435
2	Cul-de-sac	83.30	896
TOTAL		123.80	1332

PLOT AREA DETAILS		
Plot No	Extent in	
	Sq.m	Sq.ft
1	73.20	788
2	100.30	1079
3	99.70	1073
4	121.20	1304
5	118.00	1270
<b>TOTAL</b>	<b>512.40</b>	<b>5515</b>

OWNER
REGISTERED ENGINEER
COLOUR INDEX
EWS PLOTS —■
PARK —■
CHANNEL —■