

KURINJI NAGAR

LAYOUT SITE AT R.S.NOS: 27/3,27/7 OF PILLAYARKUPPAM REVENUE VILLAGE & R.S.NO: 286/9 OF SELIAMEDU REVENUE VILLAGE, BAHOUR TALUK, BAHOUR COMMUNE PANCHAYAT, PUDUCHERRY

The Plot Nos. 40, 41pt, 42, 43, 73, 74, 75 is not regularized under the Scheme of regularization of Layouts.



IN-PRINCIPLE LAYOUT FRAME WORK APPROVAL ISSUED VIDE NO.: 904/1284/PPA/Z(BCP/LAYOUT/J.P. APP)/2018-19 DATED: 11 FEB 2019

MEMBER SECRETARY
PUDUCHERRY PLANNING AUTHORITY

★ Subject to the fulfilment of conditions stipulated in the permit

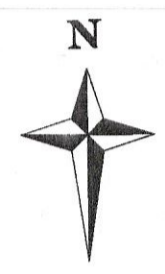
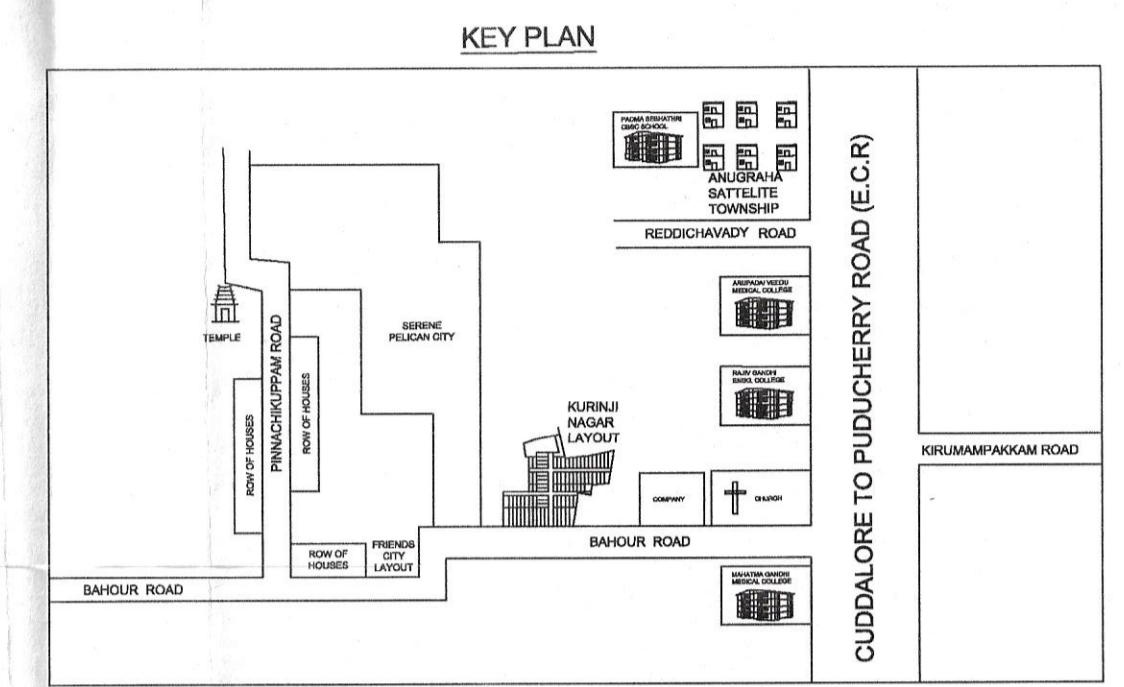
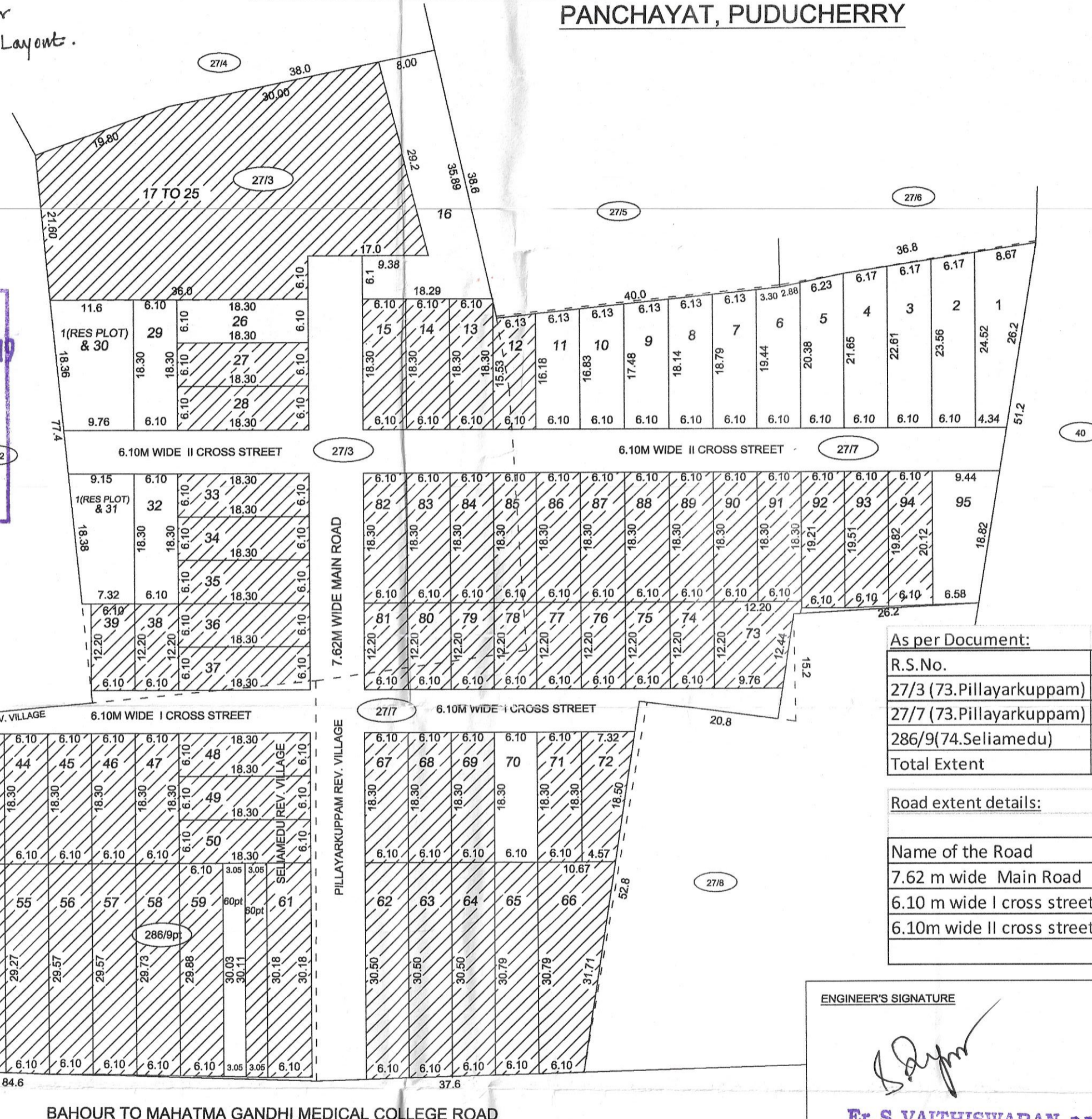

- - - FMB BOUDDARY
- LAYOUT BOUDDARY
- ▨ SOLD PLOTS
- UNSOLD PLOTS

Layout extent Details:

R.S.No.	Extent in sq.mt	Description	Area in sq.mt.
27/3 (73.Pillayarkuppam)	5100	Unsold plots area	2969.433
27/7 (73.Pillayarkuppam)	6100	Sold plots area	8911.09
286/9(74.Seliamedu)	3703	Road area	2171.3
Total Extent	14903	Total area	14051.823

Road extent details:

Name of the Road	Length	Width	Extent in Sq.mt
7.62 m wide Main Road	115.735	7.62	881.9
6.10 m wide I cross street	91.7377	6.1	559.6
6.10m wide II cross street	119.639	6.1	729.8
Total Extent:			2171.3

PLOT NO.	AREA IN SQ.MT.	PLOT NO.	AREA IN SQ.MT.
1	160.900	54	178.372
2	146.640	55	179.301
3	140.820	56	180.230
4	134.990	57	180.695
5	128.192	58	181.624
6	121.100	59	182.553
7	116.600	60	182.745
8	112.640	61	183.946
9	108.640	62	185.805
10	104.646	63	185.805
11	100.680	64	186.734
12	103.122	65	187.663
13	111.483	66	261.799
14	111.483	67	111.483
15	111.483	68	111.483
16	307.321	69	111.483
17 to 25	753.530	70	111.483
26	111.483	71	111.483
27	111.483	72	108.696
28	111.483	73	122.631
29	111.483	74	74.322
30	111.483	75	74.322
31	111.483	76	74.322
32	111.483	77	74.322
33	111.483	78	74.322
34	111.483	79	74.322
35	111.483	80	74.322
36	111.483	81	74.322
37	111.483	82	111.483
38	74.322	83	111.483
39	74.322	84	111.483
40	167.224	85	111.483
41	111.483	86	111.483
42	111.483	87	111.483
43	111.483	88	111.483
44	111.483	89	111.483
45	111.483	90	111.483
46	111.483	91	114.270
47	111.483	92	117.986
48	111.483	93	119.844
49	111.483	94	121.702
50	111.483	95	151.900
51	263.378	Res. Plot1	150.800
52	176.514	Total Extent	11880.523
53	177.443		

ENGINEER'S SIGNATURE
S. Vaithiswaran
Er. S. VAITHISWARAN, B.E.,
Registered Engineer
Reg.No: 3-426/PPA/LIC/2002
No.16, Nehru Street,
Muthulingampet, Lawspet,
Puducherry-6.

OWNER'S SIGNATURE
S. Senthil

ALL MEASUREMENTS ARE IN METRE